

ODIS

IRRIGATION EQUIPMENT LTD.

FOOT VALVE

SERIES

189

APPLICATIONS

- Used to ensure that the pump supply line remains full.
- Simple structure without spring guarantees trouble free operation.



ODIS Filtration *is The Heart* of Every Irrigation System

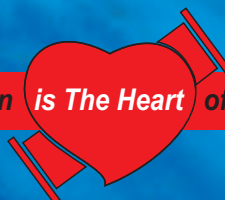

DESCRIPTION

The foot valve is designed to ensure that the pump supply line remains full.

Its simple structure (without springs) guaranties trouble free operation.

The foot valve has a shaft connected to the sealing disc. When the pump starts operation, the suction force overcomes the weight of the shaft and the weight of the sealing disc and the water column, opening the foot valve and. water is pumped without interference. When the pump is shut off, the weight of the sealing disc and the weight of the shaft and the water column will close the foot valve and the pump supply line will stay full .

The foot valve is installed at the outlet of the self cleaning strainer (series 181).
The foot valve must be installed vertically.

Available in the following sizes: 4", 6", 8", 10", 12", 14", 16"

The foot valve has a 100 micron protective coating of extra durable polyester applied electrostatically and oven cured on a zinc - phosphate layer for maximal anti corrosion protection.

Dimensions & Weight

Metric Units/ U.S. Units

Model	B		D	H		Weight	
	mm	inch	inch	mm	inch	kg	lbs
18904	100	4"	11	330	13	18	40
18906	150	6"	13	390	15.3	25	55
18908	200	8"	16	490	19.3	36	79
18910	250	10"	19	560	22	48	106
18912	300	12"	22	630	24.8	62	137
18914	350	14"	24	700	27.5	71	156
18916	400	16"	26	770	30.3	81	178

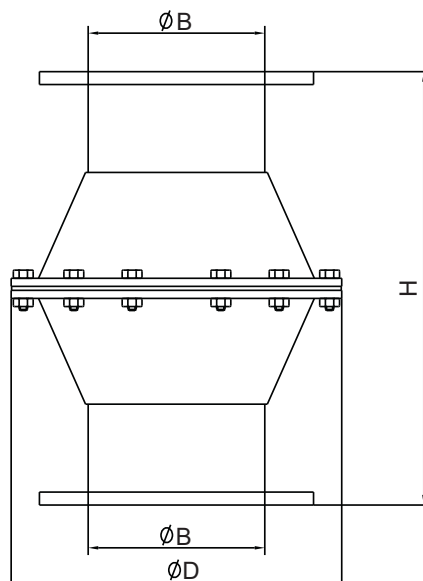

Recommended Flow Rates

Metric Units/ U.S. Units

Model	Inlet/Outlet Diameter		Max. Flow Rate	
	inch	mm	m ³ /h	U.S. gpm
18904	4"	100	100	440
18906	6"	150	230	1000
18908	8"	200	380	1700
18910	10"	250	550	2400
18912	12"	300	750	3300
18914	14"	350	1000	4400
18916	16"	400	1200	5300

Protective Coating

100 micron extra-durable polyester, applied electrostatically and oven-cured on a zinc-phosphate layer for maximal anti-corrosion protection.

Heavy galvanized coating can be supplied on special order.

How To Order Odis Foot Valve

1. Catalogue Number of the foot valve.
2. Max. Pressure.
3. Flange type.
4. Other than standard material required for the body or the gasket.
5. Special Coating Requirements.

ILLUSTRATED PARTS BREAKDOWN

NO.	DESCRIPTION
1	Upper Body
2	Lower Body
3	Slide Bar Assembly
4	Body Gasket

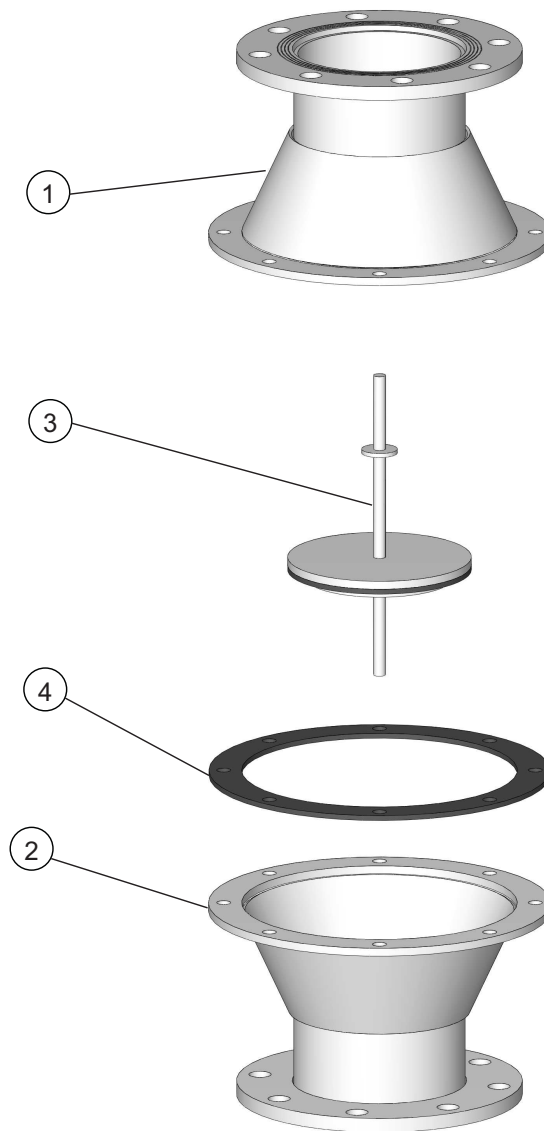

GENERAL INSTRUCTIONS

Installation

- The foot valve must be installed vertically.
- The foot valve is installed directly at the outlet of the preliminary suction strainer.
- Flow direction is clearly marked by an arrow.

Maintenance

- Each foot valve is supplied with detailed maintenance instructions, as well as assembly, installation and operation instructions.
- Any damage to the protective coating of filter must be repaired without delay.
Prior to the application of the protective paint, thoroughly clean the damaged spot with wire brush.

PACKING / SHIPPING DATA

Metric Units

Model	Inlet / Outlet (inch)	Gross * Weight (kg)	Packaging	Gross Volume (m ³)
18904	4"	20	Packed in a carton	0.03
18906	6"	27	Packed in a carton	0.05
18908	8"	38	Packed in a carton	0.1
18910	10"	51	Packed in a carton	0.15
18912	12"	65	Packed in a carton	0.22
18914	14"	75	Packed in a carton	0.3
18916	16"	84	Packed in a carton	0.4

U.S. Units

Model	Inlet / Outlet (inch)	Gross * Weight (lbs)	Packaging	Gross Volume (cu.ft)
18904	4"	44	Packed in a carton	1
18906	6"	60	Packed in a carton	1.8
18908	8"	84	Packed in a carton	3.5
18910	10"	112	Packed in a carton	5.3
18912	12"	143	Packed in a carton	7.8
18914	14"	165	Packed in a carton	10.6
18916	16"	185	Packed in a carton	14

* Gross weight includes packaging materials.